

Location

Location Map

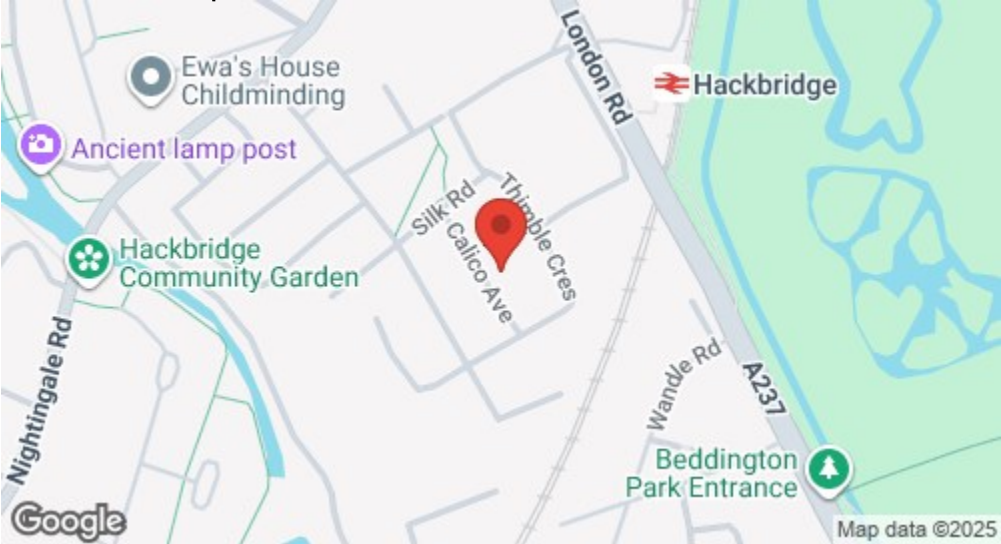

EPC Graph

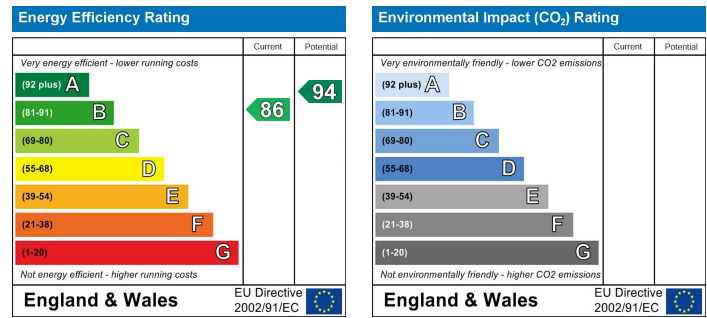

Important Note

Centro Residential Sales and Lettings limited have not tested any services, heating system, electrical system, appliances, fixtures and fittings, that may be included in this property and would advise interested parties to satisfy themselves as to their condition or investigating the presence of any deleterious materials.

Viewing: Strictly by appointment through:

CENTRO RESIDENTIAL SALES AND LETTINGS LIMITED

Tel: 020 8401 5000

E-mail: [residential@centro.plc.uk](mailto:residential@centro.plc.uk)

See a selection of our properties at [www.centro.plc.uk](http://www.centro.plc.uk)

£2,650 Per Month - 23rd December 2025

Calico Avenue, Wallington, SM6 7FZ



Description

- New Build Development
- Off Street Parking
- Private Garden
- Three Bathrooms
- High Spec Finish
- Available Now
- EPC Rating B
- Council Tax Band E

Features

- Electric Heating
- Double Glazing

What you need to know

- Term: 12 months
- Rent: £2650pcm exclusive of bills
- Security deposit: £3057.00
- Council Tax Band: E
- Energy Rating: B



Floor Plan

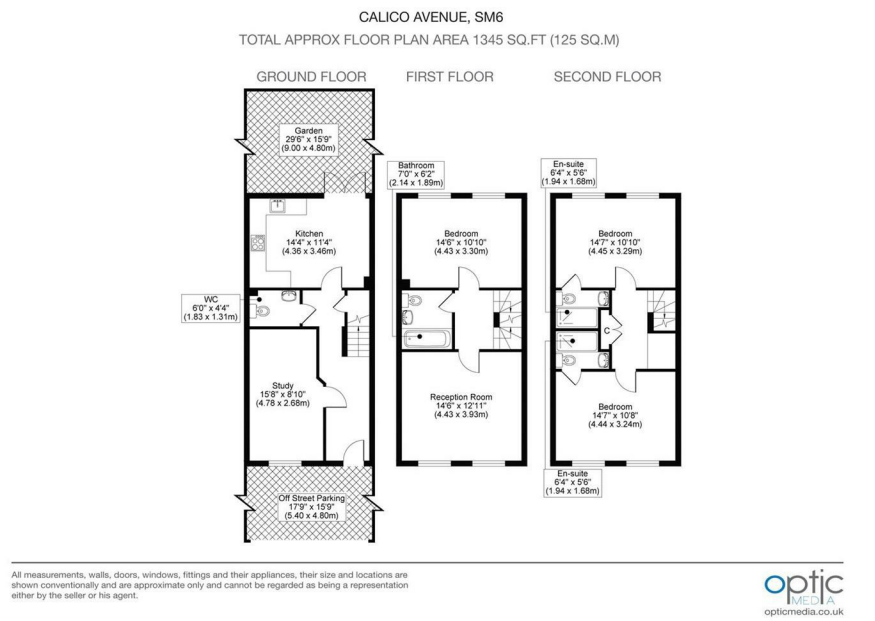

For illustration purposes only



All dimensions and measurements are approximate and for guidance only.

*Just Centro's Opinion...*

Welcome to this stunning new build townhouse located on Calico Avenue in the heart of Hackbridge

As you enter, you are greeted by a huge walkway, allowing access to a converted office which can also be used as a spare room, and an open plan kitchen eating area giving direct access to the garden. The modern design is complemented by an abundance of natural light, creating a warm and inviting atmosphere throughout the home. The property boasts three double bedrooms, each thoughtfully designed to offer both comfort and privacy. Additionally, there are three well-appointed bathrooms, ensuring convenience for all residents.

Situated close to Hackbridge Station, this property offers excellent transport links, making commuting to London and beyond a breeze. The surrounding area is rich in local amenities, including shops, parks, and schools, providing everything you need within easy reach.

Offered unfurnished and available now, call us to arrange a viewing.

Additional Photos

